



**bell & spina**

architects

building  
envelope  
specialists

planners

**Owner:**  
Syracuse City School  
District

**Size or Cost:**  
64,000 sf

215 Wyoming Street  
Suite 201  
Syracuse, NY 13204  
315 • 488-0377  
315 • 487-5947 fax

1151 Pittsford-Victor Rd  
Suite 125  
Pittsford, NY 14534

585 • 200-5038  
585 • 248-9532 fax

info@bellandspina.com  
www.bellandspina.com

## SYRACUSE CITY SCHOOL DISTRICT ED SMITH ELEMENTARY SCHOOL Roof Replacement

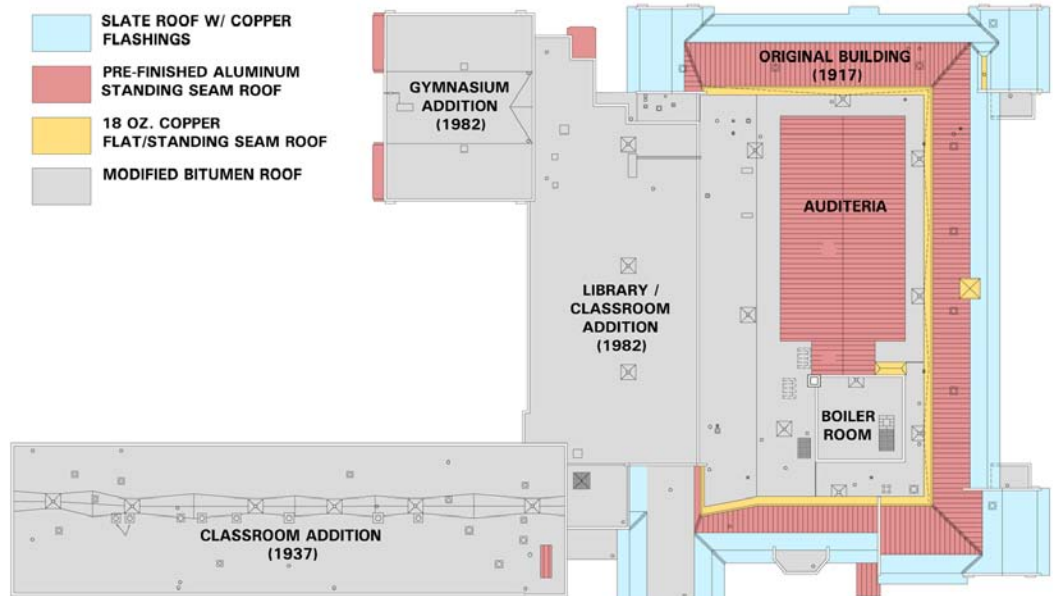

Plan showing multiple, integrated roof systems



Before



New standing seam copper, pre-finished aluminum & flat roofs

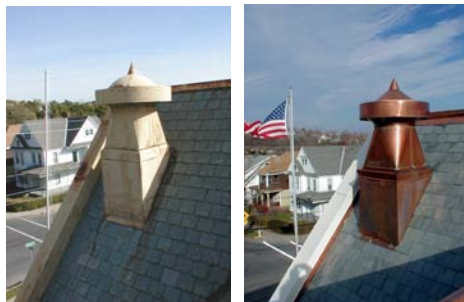

Before

After

**1<sup>st</sup> PLACE  
WINNER**

2005  
Roof Consultants Institute  
Excellence in Large  
Roofing / Waterproofing  
Project Documents

The Ed Smith Elementary School roofs offered numerous challenges: technical, aesthetic and historic. The school is partially roofed in natural slate with exposed rafter tails, fitting comfortably into its residential setting. A life cycle cost analysis for all materials being considered was performed.

Included in the construction of the complex roof were:

- Slate roofing
- Flat-seamed copper roofing
- Copper flashings
- Pre-finished aluminum
- Modified bitumen systems

Historically significant features, such as the cupola, were replicated and clad in copper. Wood and masonry repairs, new copper gutters and restoration of the historic stained-glass windows were also included.